

REV	ECN NO	CONTENT	DATE	ENGINEER
A0		INITIAL RELEASE	/	SGF

NOTES:

SPECIFICATION:

- CURRENT RATING: 3.0A MAX.
- VOLTAGE: 100 VAC
- TEMPERATURE RANGE: -30 °C ~ 85 °C
- CONTACT RESISTANCE: 40 MILLIONHM MAX.
- INSULATION RESISTANCE: 100 MEGOHMS MIN.
- INSERTION FORCE : 5N~20N
- UNMATING FORCE: 8N~20N
- DURABILITY: 10,000 CYCLES

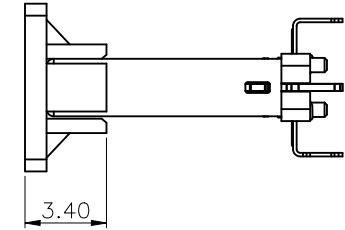
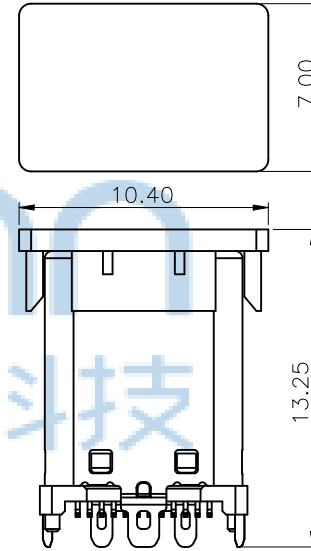
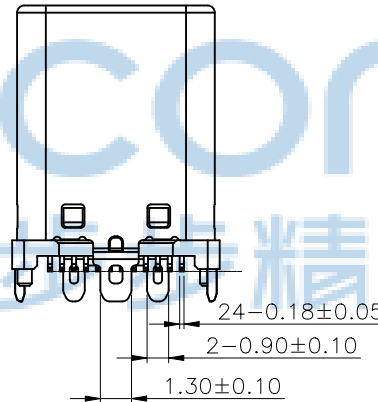
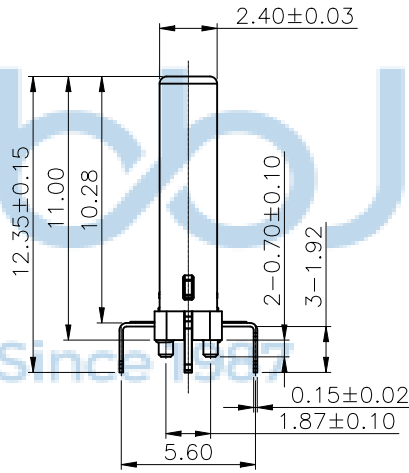
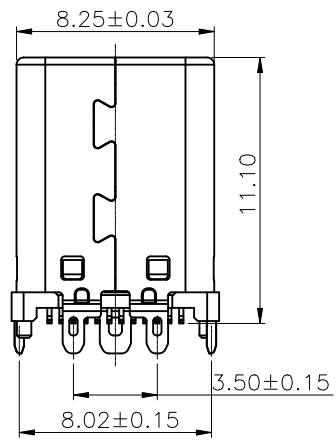
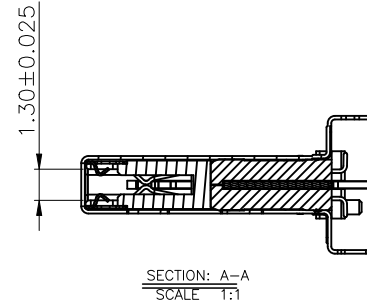
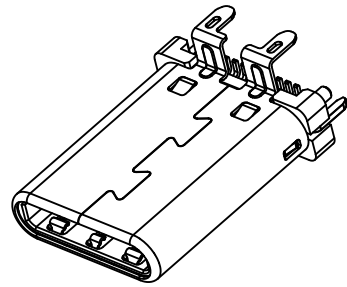
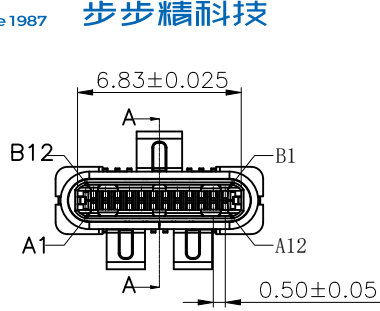

PIN	SIGNAL NAME	PIN	SIGNAL NAME
A1	GND	B12	GND
A2	SSTXP1	B11	SSRXP1
A3	SSTXN1	B10	SSRXN1
A4	VBUS	B9	VBUS
A5	CC1	B8	SBU2
A6	DP1	B7	DN2
A7	DN1	B6	DP2
A8	SBU1	B5	CC2
A9	VBUS	B4	VBUS
A10	SSRXN2	B3	SSTXN2
A11	SSRXP2	B2	SSTXP2
A12	GND	B1	GND

Added suction cap view  
SCALE: 1:1

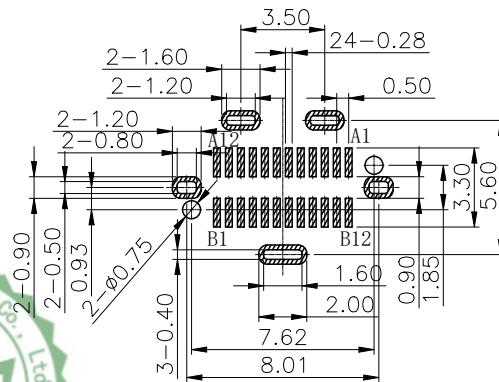
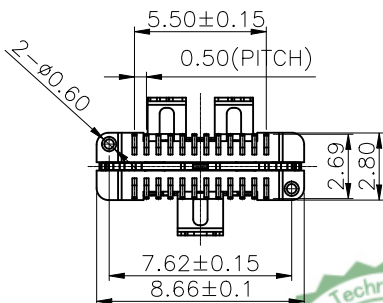

RECOMMENDED PCB LAYOUT(L=0.80±0.05)  
COMPONENT SIDE(GENERAL TOLERANCE:±0.05)



NO.	DESCRIPTION	MATERIAL	REMARKS	Q'TY
6	HOUSING	HIGH TEMPERATURE PLASTIC,PA9T	BLACK	1PCS
5	CAP	HIGH TEMPERATURE PLASTIC,LCP	BLACK	1PCS
4	EMI	STAINLESS STEEL,SUS304	---	2PCS
3	LATCH	STAINLESS STEEL,SUS301	TIN: 80-120u"Min./Ni base: 50u"Min. Plated	1PCS
2	SHELL	STAINLESS STEEL,SUS304	Ni: 50u"Min. Plated	1PCS
1	INSERT MOLDING	HIGH TEMPERATURE PLASTIC (HOUSING,LCP;TERMINAL,C5191)	CONTACT: Au: 3u"Min. Ni base: 50u"Min., BLACK	2PCS

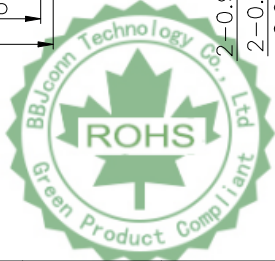

THIS DOCUMENT IS THE  
SOLE PROPERTY OF

bbJconn Technology Co.,Ltd.  
Corporation AND SHOULD  
NOT BE USED IN WHOLE  
PRIOR WRITTEN PERMISSION.

PDWG NO: 0366-2

**深圳市步步精科技有限公司**

.X: ±0.38 X': ±3"  
.XX: ±0.25 .X': ±2"  
.XXX: ±0.13 .XX': ±1"

APPD JM\_Zheng

CHKD LYX

DR SGF

NAME: TYPE-C 24P 公头 180度 三脚插  
双排SMT H=11.1 带柱 编带

PJ NO: 126-124-240003-N5G

SIZE:A4 DRW NO:

FINISH:SEE NOTES MAT'L:SEE NOTES

SCALE:N/A REV:A0 UNIT:mm PAGE:1/2

REV	ECN NO	CONTENT	DATE	ENGINEER
A0		INITIAL RELEASE	/	SGF

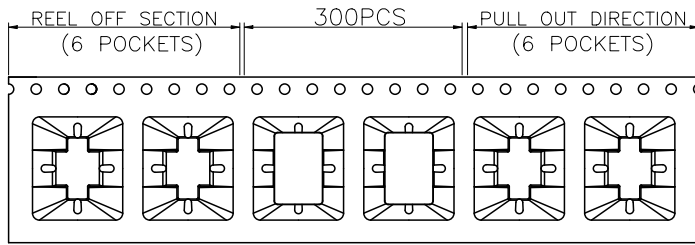

① 产品入载带示意图

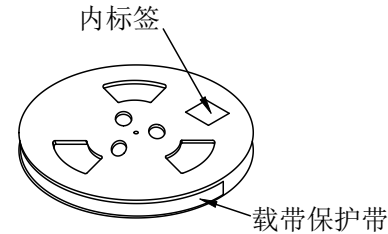
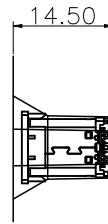

② 卷盘贴标签示意图

③ 11盘产品叠层示意图

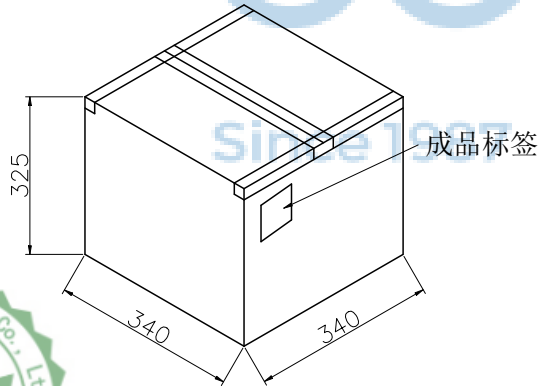

⑤ 外箱封箱示意图

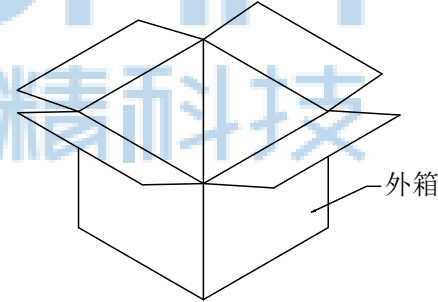

④ 产品入外箱示意图



	REEL	CARTON
CONNECTOR (PCS)	300	3300

**包装说明:**

1. 将检验好的成品;SMT朝下放入载带底部;每卷装300PCS产品;具体如图一所示
2. 将包装好的产品;每盘必需贴上内标签;具体如图二所示
3. 将贴好内标签的产品每11盘叠;具体如图三所示
4. 装好后并封好纸箱及贴好相关标签;具体如图五所示;  
(产品包装的标签,如客户有要求,请按客户要求包装出货)
5. 载带前面留6PCS空格,后面留6PCS空格
6. COVER与CARRY剥离力:50-125g,速度:300mm/分钟左右,剥离角度:165°-180°

THIS DOCUMENT IS THE SOLE PROPERTY OF BBJconn Technology Co.,Ltd. Corporation AND SHOULD NOT BE USED IN WHOLE PRIOR WRITTEN PERMISSION.		<b>深圳市步步精科技有限公司</b>	
.X: ±0.38 .XX: ±0.25 .XXX: ±0.13		X': ±3" .X': ±2" .XX': ±1"	
NAME:	TYPE-C 24P 公头 180度 三脚插 双排SMT H=11.1 带柱 编带		
APPD:	JM_Zheng	PJ NO: 126-124-240003-N5G	
CHKD:	LYX	SIZE:A4   DRW NO:	
PDWG NO: 0366-2		DR	SGF
FINISH:SEE NOTES		MAT'L:SEE NOTES	
SCALE:N/A		REV:A0	UNIT:mm   PAGE:2/2