

| REV. | ECN NO. | CONTENT | DATE | ENGINEER |
|------|---------|-----------------|------|----------|
| A0 | | Initial release | / | TSP |

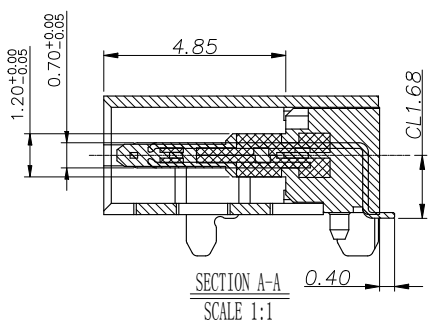

NOTE:

- 1.MATERIAL SPECIFICATION:**
 - 1.HOUSING:HIGH TEMPERATURE RESISTANT PLASTIC,UL94 V-0.
 - 2.CONTACTS:COPPER ALLOY
 - 3.MID PLATE: STAINLESS STEEL
- 2.PLATING SPECIFICATION:**
 - 2-1.CONTACTS:
Ni 50u" MIN. UNDER PLATED OVER ALL.
Au 30u" PLATED ON THE FUNCTIONAL AREA OF CONTACT.
(GOLD PLATING THICKNESS FOLLOW)
GOLD FLASH PLATING ON SOLDER AREA
 - 2-2.FRONT SHELL:
Ni 30u" MIN. UNDER PLATED OVER ALL.
- 3.MECHANICAL PERFORMANCE,**
 - 3-1.INSERTION FORCE: 0.5~2.0kgf.
 - 3-2.REMOVAL FORCE: 0.8kgf~2.0kgf.
 - 3-3.DURABILITY: 10000 CYCLES.
- 4.ELECTRICAL PERFORMANCE,**
 - 4-1. CURRENT RATING: 5A
VOLTAGE RATING: 20V
 - 4-2.INSULATION RESISTANCE: 100MΩ MIN
 - 4-3.DIELECTRIC WITHSTAND VOLTAGE,AC 100V FOR 1 MINUTE.
 - 4-4.LOW CONTACT RESISTANCE: INITIAL 40MΩ
AFTER 50MΩ
- 5. ENVIRONMENTAL PERFORMANCE:**
 - OPERATING TEMPERATURE: -30°C~+80°C.
- 6.IR REFLOW:**
THE PEAK TEMPERATURE ON THE BOARD SHALL BE MAINTAINED FOR 10 SECONDS AT 260°C.

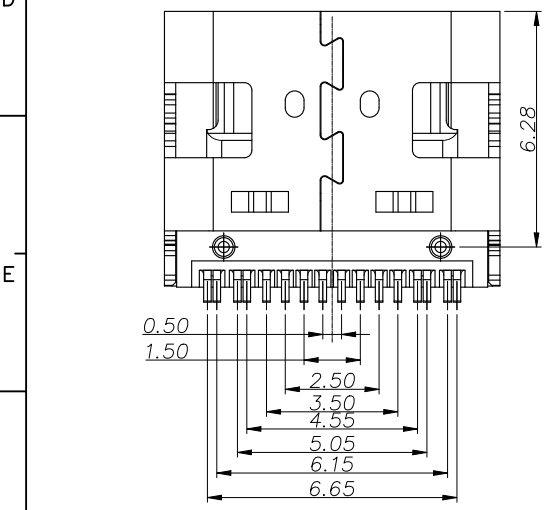
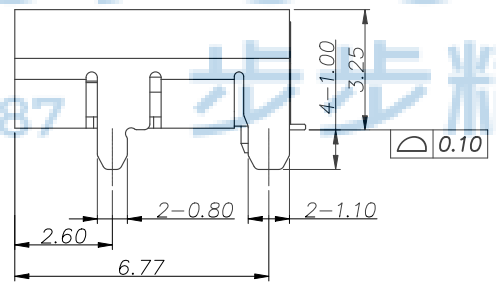
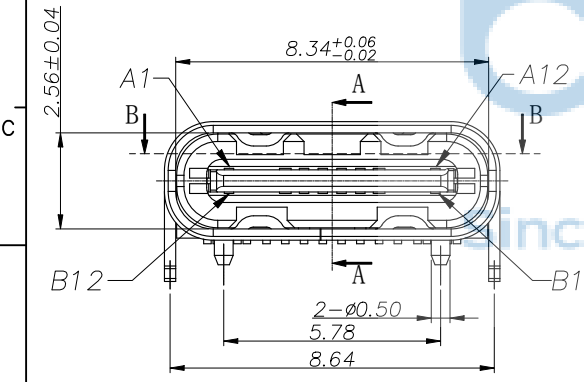
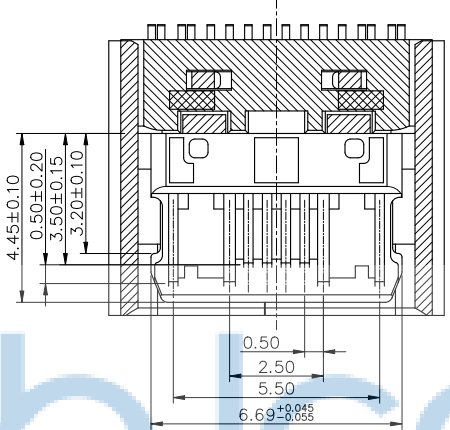
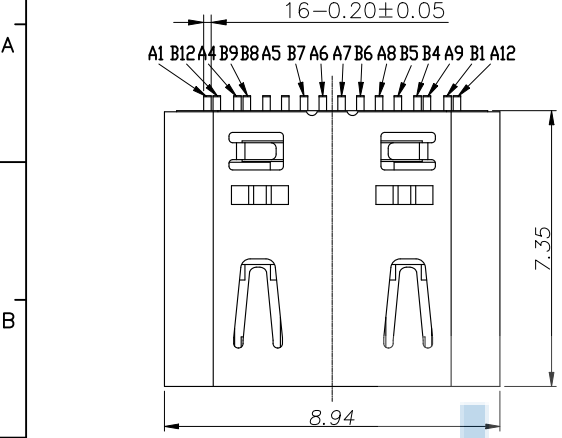

| 4 | SHELL | SUS304 T=0.30MM | Ni 30u"MIN | 1PCS |
|-----|-----------------|-----------------|---|------|
| 3 | SHIELDING PLATE | SUS301 T=0.15MM | N/A | 1PCS |
| 2 | CONTACT | C7025 T=0.15MM | Mating area 30u"Au Solder Tails: G/F Underplate: 50u"Min Ni overall | 2SET |
| 1 | INSERT MOLDING | LCP UL94V-0 | BLACK | 1PCS |
| NO. | DESCRIPTION | MATERIAL | REMARKS | |

THIS DOCUMENT IS THE SOLE PROPERTY OF **深圳市步步精科技有限公司**
BBJconn Technology Co.,Ltd.
CORPORATION AND SHOULD NOT BE USED IN WHOLE OR IN PART WITHOUT PRIOR WRITTEN PERMISSION.
PDWG.NO: 0100-2

NAME: TYPE-C 16P 母座 SMT 高导电 镀金30U 板上四脚插 带柱 外壳四脚点带弹不折弯凸包印子 L=7.35 CH=1.68 编带

APPD. JM_Zheng
CHKD. LYX
DR. TSP

PJ. NO.: 126-273-160003-V2G
SIZE: A4 DRW NO.:
FINISH: SEE NOTES MAT'L.: SEE NOTES
SCALE: N/A REV.: A0 UNIT: mm PAGE: 1/3

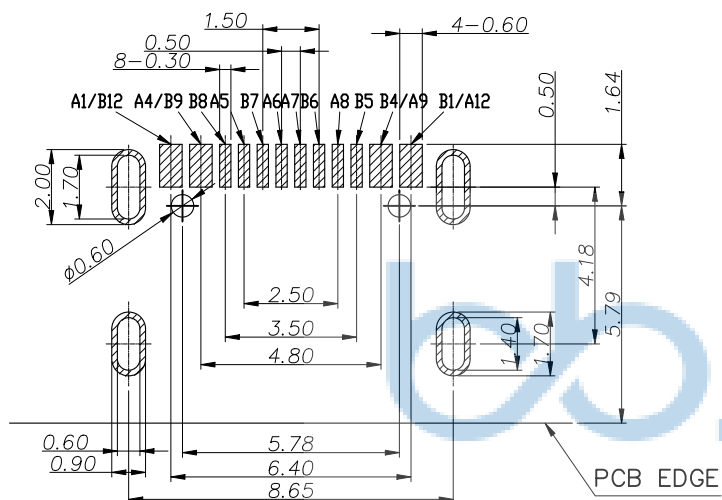
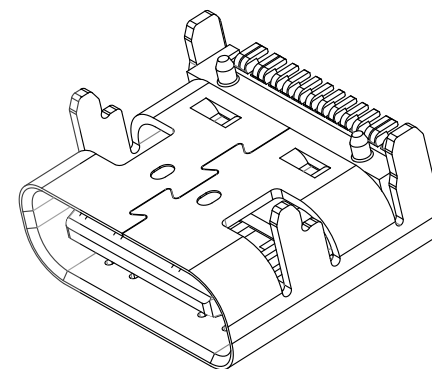
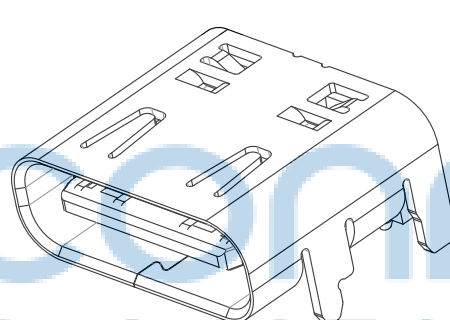

RECOMMEND P.C.B LAYOUT (COMPONENT SIDE)
TOLERANCE FOR PCB LAYOUT IS ± 0.05

USB TYPE-C PIN ASSIGNMENTS

| PIN NUMBER | SIGNAL NAME | PIN NUMBER | SIGNAL NAME |
|------------|-------------|------------|-------------|
| A1 | GND | B12 | GND |
| A4 | VBUS | B9 | VBUS |
| A5 | CC1 | B8 | SBU2 |
| A6 | Dp1 | B7 | Dn2 |
| A7 | Dn1 | B6 | Dp2 |
| A8 | SBU1 | B5 | CC2 |
| A9 | VBUS | B4 | VBUS |
| A12 | GND | B1 | GND |



| | | | |
|---|----------|---------------------|---|
| THIS DOCUMENT IS THE SOLE PROPERTY OF BBJconn Technology Co., Ltd. Corporation AND SHOULD NOT BE USED IN WHOLE OR IN PART WITHOUT PRIOR WRITTEN PERMISSION. | | 深圳市步步精科技有限公司 | |
| APPD. | JM_Zheng | NAME: | TYPE-C 16P 母座 SMT 高导电 镀金30U 板上四脚插 带柱 外壳四脚点带弹不折弯凸包印子 L=7.35 CH=1.68 编带 |
| CHKD. | LYX | PJ. NO.: | 126-273-160003-V2G |
| DR. | TSP | SIZE: | A4 |
| PDWG. NO: | 0100-2 | DRW NO.: | |
| | | FINISH: | SEE NOTES |
| | | MAT'L.: | SEE NOTES |
| | | SCALE: | N/A |
| | | REV.: | A0 |
| | | UNIT: | mm |
| | | PAGE: | 2/3 |

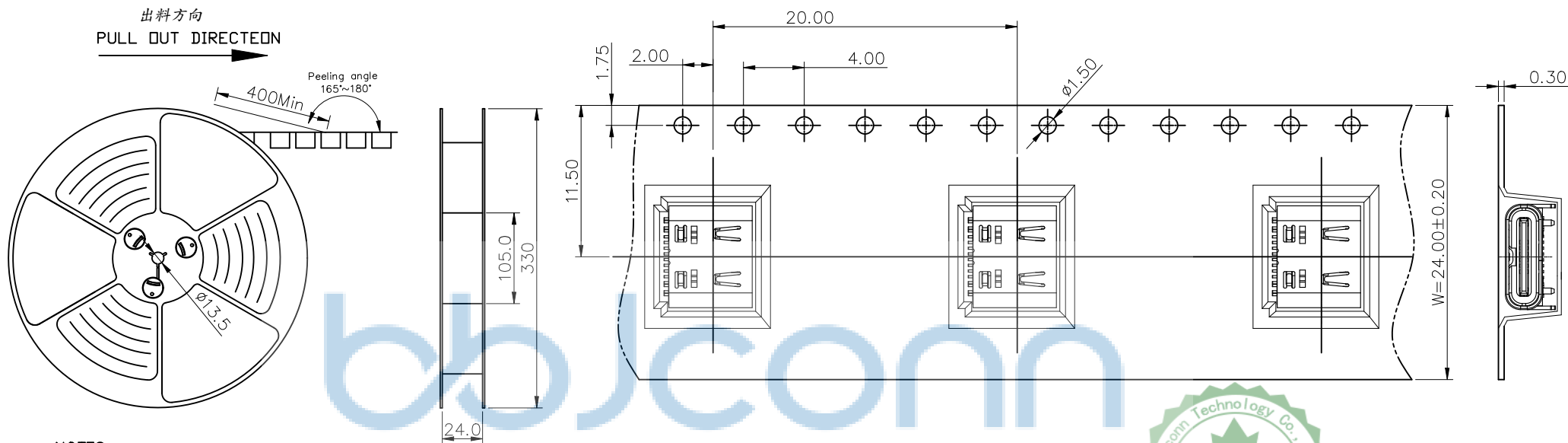

NOTES

1. 帶引導長度
LEAD TAPE LENGTH
出料方向
PULL OUT DIRECTION

出料方向
PULL OUT DIRECTION

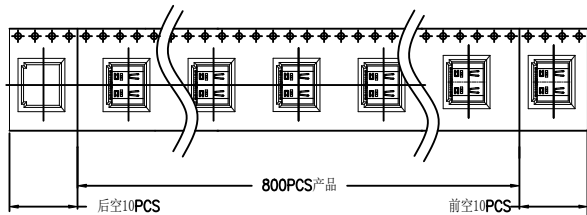

2. 上帶 剝離力為：0.1~1.3N(10.2gf~130gf)
PEELING OFF FORCE OF TOP TAPE: 0.1~1.3N(10.2gf~130gf)
出貨運輸過程中一定注意：
THIS REQUIREMENT SHOULD BE APPLIED AT SHIPMENT：
卷帶在運輸過程中不能散開
PEELING OFF SHOULD NOT BE ALLOWED DURING TRANSPORTATION

Since 1987

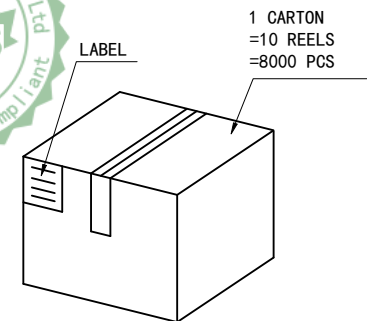
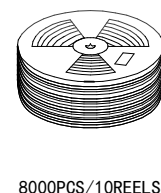
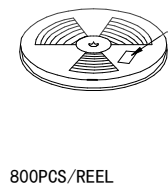

CARTON: L33.5*W33.5*H30.5cm

包裝明細表 (The detail of the packing)

| 產品料號 (Product No.) | 包裝容量 (Packing Capacity) | | | 重量 Weight (Kg) | | |
|-----------------------|-------------------------|--------------|------------|----------------|-------------|---------------|
| | pcs/reel | reels/Carton | Pcs/Carton | N. W. /Pcs | N. W. /reel | N. W. /Carton |
| | 800 | 10 | 8000 | ---- | ---- | ---- |

| | | | | | |
|---|--|--|--|---|--|
| THIS DOCUMENT IS THE SOLE PROPERTY OF BBJconn Technology Co., Ltd. CORPORATION AND SHOULD NOT BE USED IN WHOLE OR IN PART WITHOUT PRIOR WRITTEN PERMISSION. | | 深圳市步步精科技有限公司 .X: ±0.38 X: ±3" .XX: ±0.25 .X: ±2" .XXX: ±0.13 .XX: ±1" | | NAME: TYPE-C 16P 母座 SMT 高導銅 鍍金30U 板上四腳插 帶柱 外壳四腳點帶彈不折彎凸包印子 L=7.35 CH=1.68 編帶 APPD. JM_Zheng CHKD. LYX DR. TSP | |
| PDWG.NO: 0100-2 | | P.J. NO.: 126-273-160003-V2G SIZE: A4 DRW NO.: FINISH: SEE NOTES MAT'L.: SEE NOTES SCALE: N/A REV.: A0 UNIT: mm PAGE: 3/3 | | | |