

REV.	ECN NO.	CONTENT	DATE	ENGINEER
A0				

A

B

C

D

E

A

B

C

D

E

NOTE:

1.MATERIAL SPECIFICATION:

- 1.HOUSING:HIGH TEMPERATURE RESISTANT PLASTIC,UL94 V-0.LCP
- 2.CONTACTS:COPPER ALLOY H65
- 3.MID PLATE: STAINLESS STEEL SUS301

2.PLATING SPECIFICATION:

2-1.CONTACTS:

- Ni 50u" MIN. UNDER PLATED OVER ALL.
- Au PLATED ON THE FUNCTIONAL AREA OF CONTACT.
- GOLD FLASH PLATING ON SOLDER AREA

2-2.FRONT SHELL:

- Ni 30u" MIN. UNDER PLATED OVER ALL.

3.MECHANICAL PERFORMANCE,

- 3-1.INSERTION FORCE: 0.5~2.0kgf.
- 3-2.REMOVAL FORCE: 0.8kgf~2.0kgf.
- 3-3.DURABILITY: 10000 CYCLES.

4.ELECTRICAL PERFORMANCE,

- 4-1. CURRENT RATING: 5A  
VOLTAGE RATING: 20V
- 4-2.INSULATION RESISTANCE: 100MΩ MIN
- 4-3.DIELECTRIC WITHSTAND VOLTAGE,AC 100V FOR 1 MINUTE.
- 4-4.LOW CONTACT RESISTANCE: INITIAL 40MΩ

5. ENVIRONMENTAL PERFORMANCE:

- OPERATING TEMPERATURE: -30°C~+80°C.

6.IR REFLOW:

- THE PEAK TEMPERATURE ON THE BOARD SHALL BE MAINTAINED FOR 10 SECONDS AT 260°C.

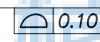
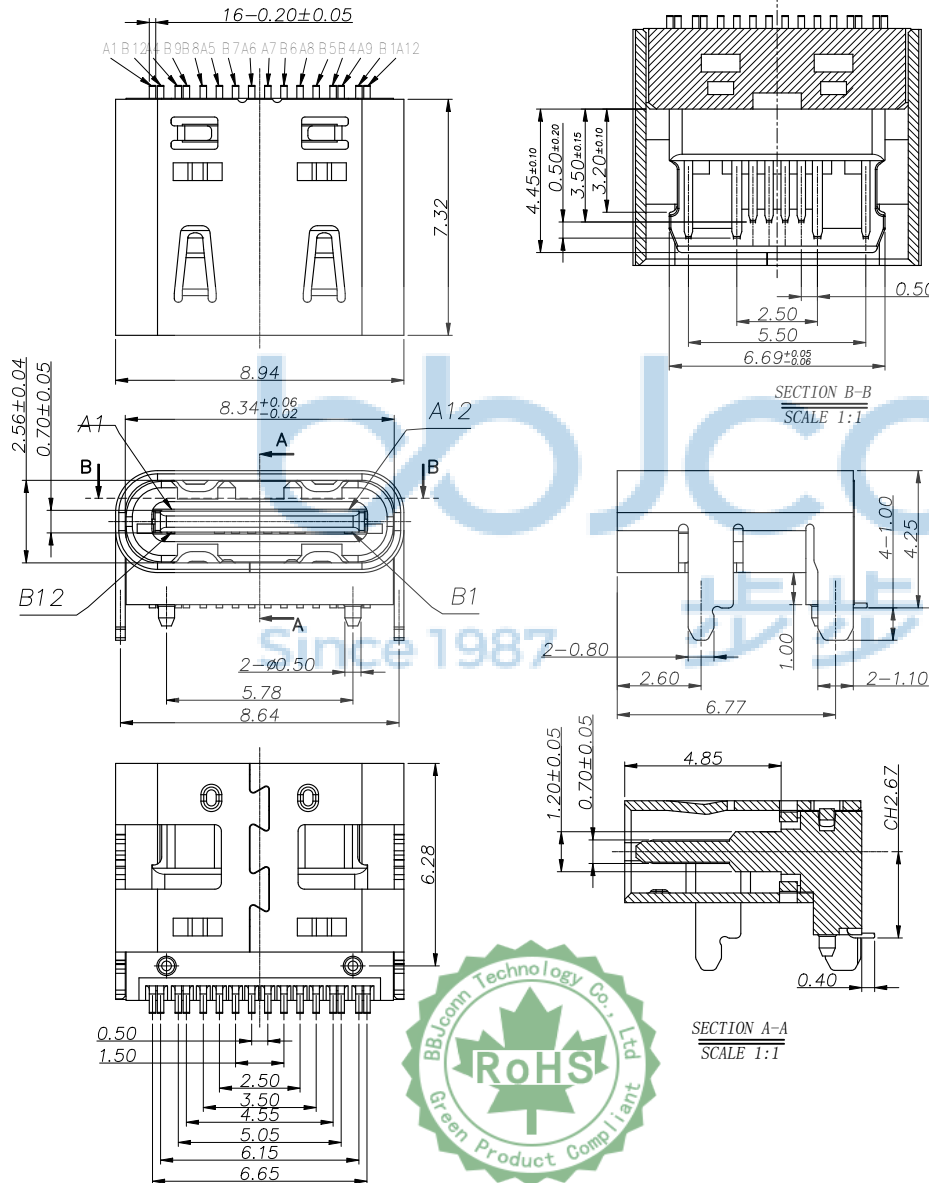

THIS DOCUMENT IS THE SOLE PROPERTY OF BBJconn Technology Co.,Ltd. CORPORATION AND SHOULD NOT BE USED IN WHOLE OR IN PART WITHOUT PRIOR WRITTEN PERMISSION.		深圳市步步精科技有限公司 Shenzhen BBJconn Technology Co.,Ltd		NAME: TYPE-C 16P Female(母座) board above(板上型) L=7.35 Padded height(垫高)1.0 CH2.67 spring
		.X: ±0.38 .XX: ±0.25 .XXX: ±0.13	X': ±3' X'': ±2' .XX': ±1'	P/N: UC.01.51-11-0058 SIZE: A4DRW NO.: FINISH: SEE NOTES SCALE:N/A
PDWG.NO: 0100-2	DR.	SGF		PAGE: 1/2

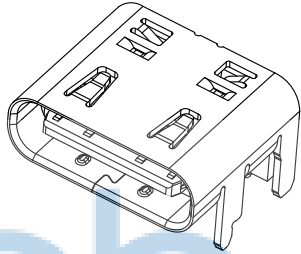

USB TYPE-C PIN ASSIGNMENTS

PTN NUMBER	SIGNAL NAME	PIN NUMBER	SIGNAL NAME
A1	GND	B12	GND
A4	VBUS	B9	VBUS
A5	CC1	B8	SBU2
A6	Dp1	B7	Dn2
A7	Dn1	B6	Dp2
A8	SBU1	B5	CC2
A9	VBUS	B4	VBUS
A12	GND	B1	GND

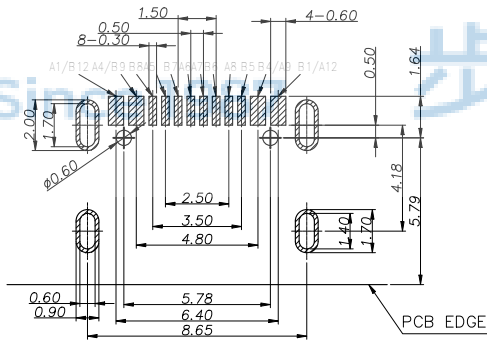

RECOMMEND P.C.B LAYOUT (COMPONENT SIDE)  
TOLERANCE FOR PCB LAYOUT IS  $\pm 0.05$



THIS DOCUMENT IS THE SOLE PROPERTY OF BBJconn Technology Co.,Ltd. Corporation AND SHOULD NOT BE USED IN WHOLE OR IN PART WITHOUT PRIOR WRITTEN PERMISSION. PDWG,NO: 0100-2	深圳市步步精科技有限公司		NAME: TYPE-C 16P 母座 板上四脚插 带柱 L=7.35 CH2.67 垫高1.0 端子SMT 带弹	
	.X: $\pm 0.38$	X': $\pm 3'$	P.J. NO.: UC.01.51-11-0058 SIZE: A4 DRW NO.:	
	.XX: $\pm 0.25$	.X': $\pm 2'$		
	.XXX: $\pm 0.13$	.XX': $\pm 1'$	FINISH: SEE NOTES MAT'L.: SEE NOTES	
	APPD. JM_Zheng 23/05'02	CHKD. LYX 23/05'02	SCALE: N/A REV.: A3 UNIT: mm PAGE: 1/1	
DR. ZY 23/05'02				

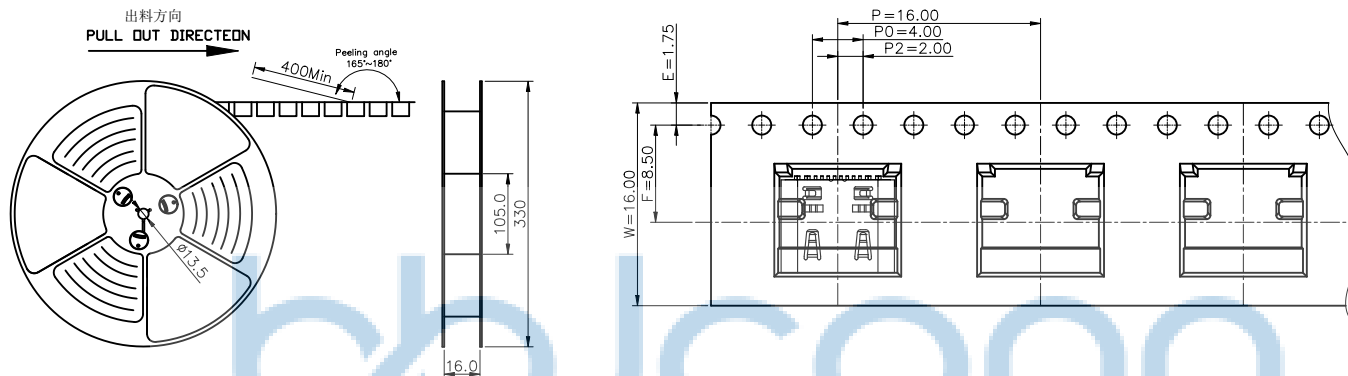

NOTES

1. 帶子引導長度  
LEAD TAPE LENGTH

出料方向  
PULL OUT DIRECTEON

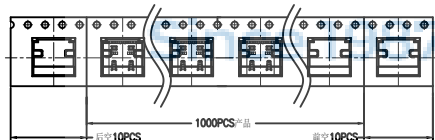

2. 上帶 剝力力為: 0.1~1.3N(10.2gf~130gf)  
PEELING OFF FORCE OF TOP TAPE:0.1~1.3N(10.2gf~130gf)

出貨`運輸過程中一定注意:  
THIS REQUIREMENT SHOULD BE APPLIED AT SHIPMENT:

卷帶在運輸過程中不能散開  
PEELING OFF SHOULD NOT BE ALLOWED DURING TRANSPORTATION

TAPE & REEL 14 PCS  
1 REEL = 1000 PCS

BOX  
DIMENSIONS:  
33.5X33.5X30.5

1 CARTON  
=14 REELS  
=14000 PCS

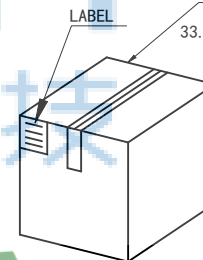
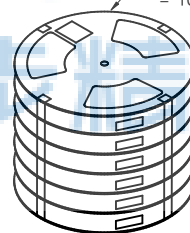

包装明细表(The detail of the packing) Carton

包装容量(Packing Capacity)			重量 Weight (Kg)		
pcs/box	boxs/Carton	Pcs/Box	N.W./Pcs	N.W./Box	G.W./Box
1000	14	14000	----	----	----

THIS DOCUMENT IS THE  
SOLE PROPERTY OF  
BBJconn Technology Co.,Ltd.  
Corporation AND SHOULD  
NOT BE USED IN WHOLE  
OR IN PART WITHOUT  
PRIOR WRITTEN PERMISSION.  
PDWG.NO: 0100-2

**深圳市步步精科技有限公司**

.X: ±0.38 X': ±3'  
.XX: ±0.25 .X': ±2'  
.XXX: ±0.13 .XX': ±1'

NAME: TYPE-C 16P 母座 板上四脚插 带柱  
L=7.35 CH2.67 垫高1.0 端子SMT 带弹

APPD. JM\_Zheng 23/05'02  
CHKD. LYX 23/05'02  
DR. ZY 23/05'02

PJ. NO.: UC.01.51-11-0058  
SIZE: A4 DRW NO.:  
FINISH: SEE NOTES MAT'L: SEE NOTES  
SCALE: N/A REV.: A3 UNIT: mm PAGE: 1/1