

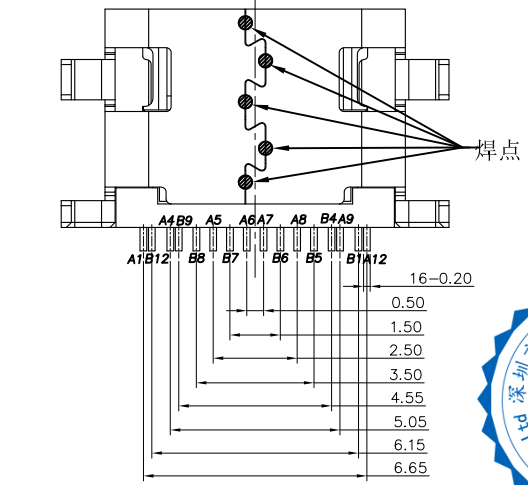

REV.	DESCRIPTION	NAME	DATE
A	NEWS ISSUE		

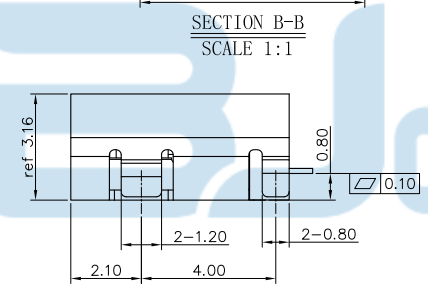

SECTION B-B
SCALE 1:1

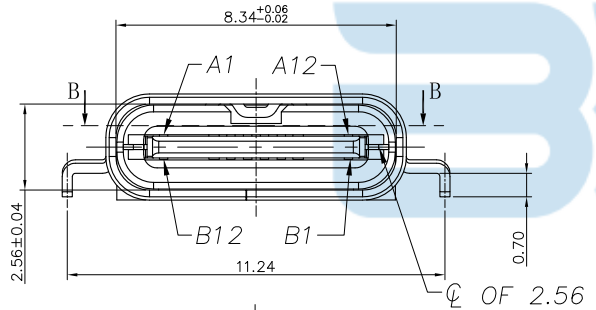
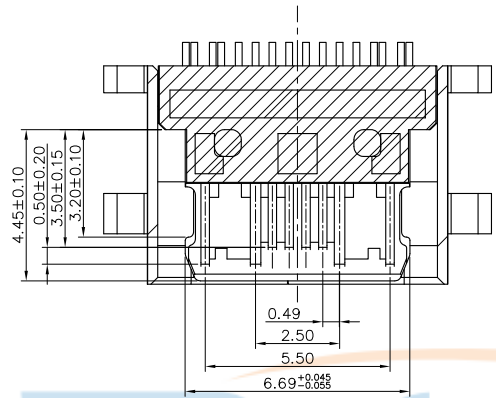
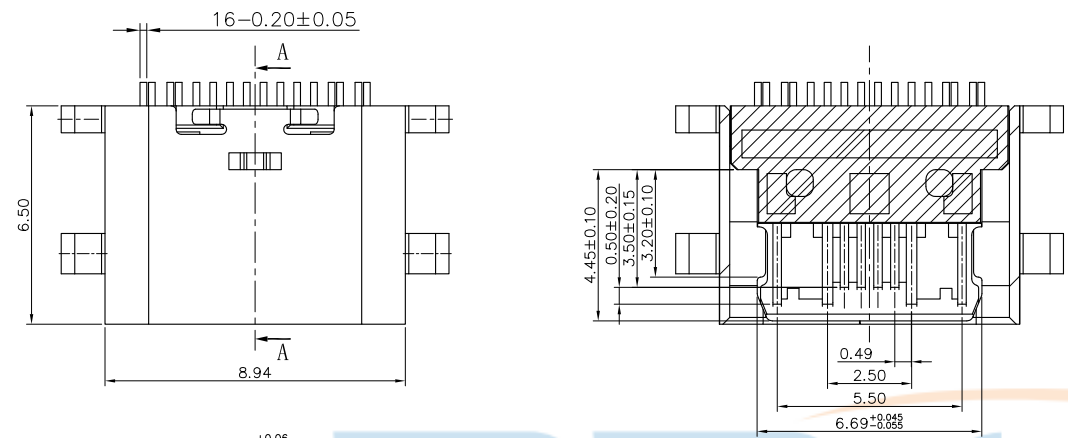

NOTE:

1. MATERIAL SPECIFICATION:
 1. HOUSING: HIGH TEMPERATURE RESISTANT PLASTIC, UL94 V-0.
 2. CONTACTS: COPPER ALLOY
 3. MID PLATE: STAINLESS STEEL
2. PLATING SPECIFICATION:
 - 2-1. CONTACTS:
 - Ni 50u" MIN. UNDER PLATED OVER ALL.
 - Au PLATED ON THE FUNCTIONAL AREA OF CONTACT.
 - (GOLD PLATING THICKNESS FOLLOW)
 - GOLD FLASH PLATING ON SOLDER AREA
 - 2-2. FRONT SHELL:
 - Ni 30u" MIN. UNDER PLATED OVER ALL.
3. MECHANICAL PERFORMANCE,
 - 3-1. INSERTION FORCE: 0.5~2.0kgf.
 - 3-2. REMOVAL FORCE: 0.8kgf~2.0kgf.
 - 3-3. DURABILITY: 10000 CYCLES.
4. ELECTRICAL PERFORMANCE,
 - 4-1. CURRENT RATING: 5A
VOLTAGE RATING: 20V
 - 4-2. INSULATION RESISTANCE: 100MΩ MIN
 - 4-3. DIELECTRIC WITHSTAND VOLTAGE, AC 100V FOR 1 MINUTE.
 - 4-4. LOW CONTACT RESISTANCE: INITIAL 40MΩ
AFTER 50MΩ
5. ENVIRONMENTAL PERFORMANCE:
 - OPERATING TEMPERATURE: -30°C~+80°C.
6. IR REFLOW:
 - THE PEAK TEMPERATURE ON THE BOARD SHALL BE MAINTAINED FOR 10 SECONDS AT 260°C.

TOLERANCE UNSPECIFIED		深圳市步步精科技有限公司 TITLE: TYPE-C 16P 母座 L=6.5 CH=0.78 沉板0.8 铜合金 端子镀金G/F 端子SMT 外壳5个焊点			
.0	±0.35				
.00	±0.25	DRAWN/ DATE		设计	TSP
.000	±0.15	CHECKED/ DATE	审核	LYX	SIZE: A4
X. °	±2.00°	APPROVED/ DATE	核准	LJP	UNIT: MM.
CUSTOMER DRAWING		PART. NO:		126-221-160013-V2G	
		SCALE: 1:1		PROJECTION	REV.: 版本
		DWG. PATH		0100-2	
				SHEET: 页码	



REV.	DESCRIPTION	NAME	DATE
A	NEWS ISSUE		

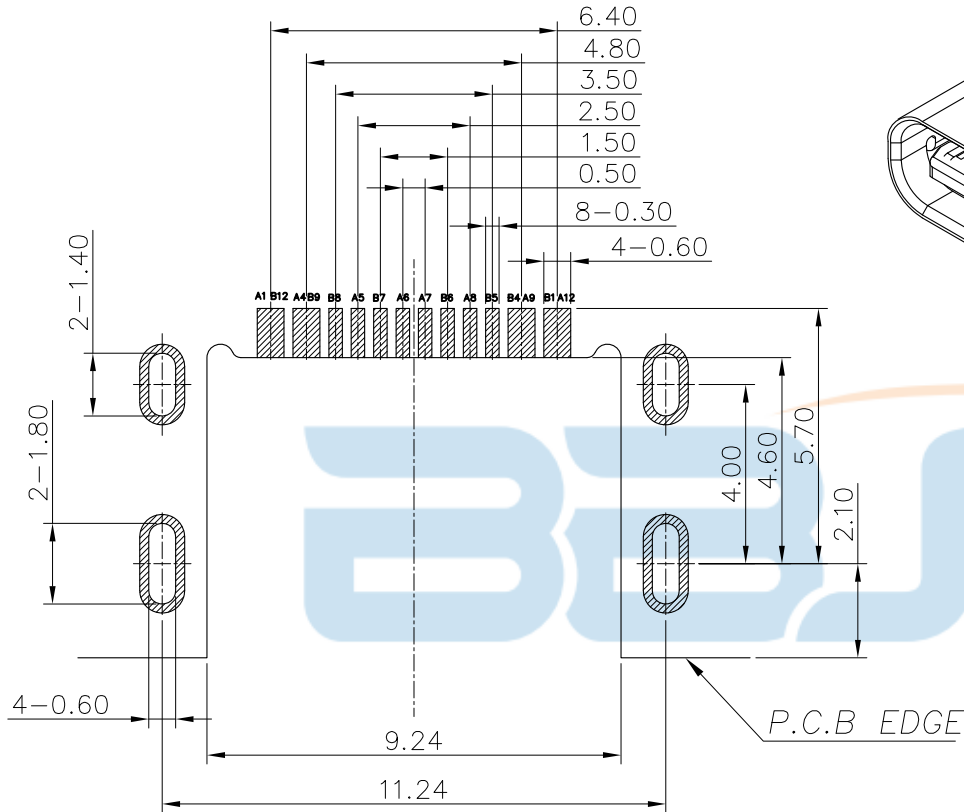
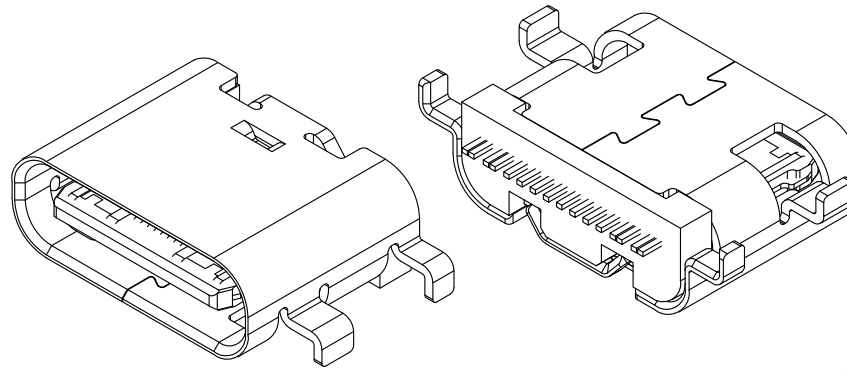

USB TYPE-C PIN ASSIGNMENTS

PIN NUMBER	SIGNAL NAME
A1	GND
A4	VBUS
A5	CC1
A6	Dp1
A7	Dn1
A8	SBU1
A9	VBUS
A12	GND

PIN NUMBER	SIGNAL NAME
B12	GND
B9	VBUS
B8	SBU2
B7	Dn2
B6	Dp2
B5	CC2
B4	VBUS
B1	GND

RECOMMEND P.C.B LAYOUT (COMPONENT SIDE)
TOLERANCE FOR PCB LAYOUT IS ± 0.05



TOLERANCE UNSPECIFIED		深圳市步步精科技有限公司 TITLE: TYPE-C 16P 母座 L=6.5 CH=0.78 沉板0.8 铜合金 端子镀金G/F 端子SMT 外壳5个焊点				
.0	± 0.35	DRAWN/ DATE	设计 TSP	SIZE: A4	UNIT: MM.	PART. NO: 126-221-160013-V2G
.00	± 0.25	CHECKED/ DATE	审核 LYX	SCALE: 1:1	PROJECTION	REV.: 版本
.000	± 0.15	APPROVED/ DATE	核准 LJP	DWG. PATH		SHEET: 页码
X.°	$\pm 2.00^\circ$					0100-2
CUSTOMER DRAWING						



出料方向

PULL OUT DIRECTEON



REV.	DESCRIPTION	NAME	DATE
A	NEWS ISSUE		

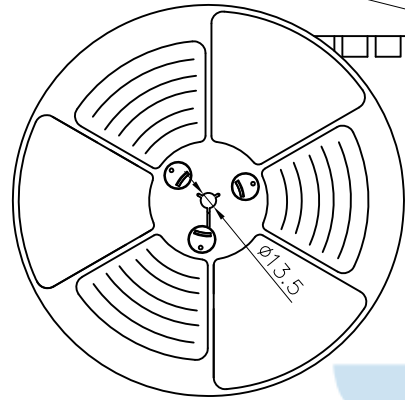

Peeling angle
165°~180°
400Min

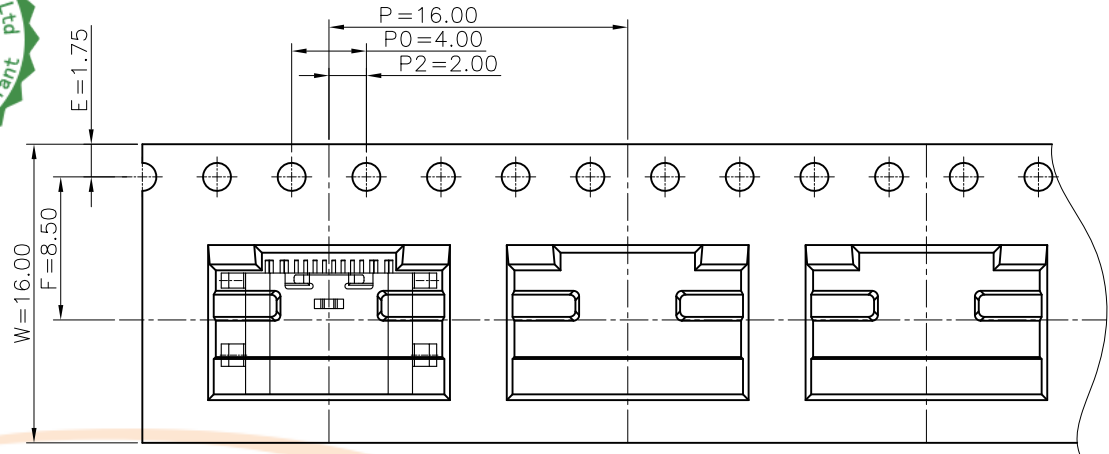

NOTES

1.帶子引導長度
LEAD TAPE LENGTH

出料方向

PULL OUT DIRECTEON

出料方向

PULL OUT DIRECTEON

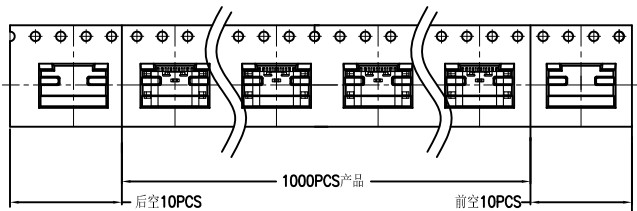

2.上帶剝力力為：0.1~1.3N(10.2gf~130gf)

PEELING OFF FORCE OF TOP TAPE:0.1~1.3N(10.2gf~130gf)

出貨運輸過程中一定注意：

THIS REQUIREMENT SHOULD BE APPLIED AT SHIPMENT：

卷帶在運輸過程中不能散開

PEELING OFF SHOULD NOT BE ALLOWED DURING TRANSPORTATION



TAPE & REEL 10 PCS

1 REEL
= 1000 PCS

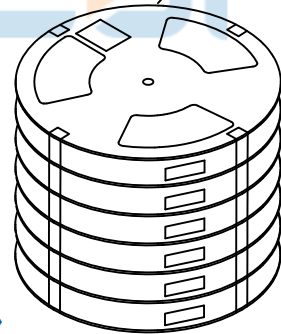

BOX

DIMENSIONS:
33.5X33.5X30.5

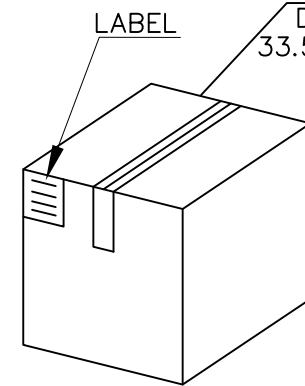

1 CARTON
=14 REELS
=14000 PCS

TOLERANCE UNSPECIFIED		.0 ±0.35		.00 ±0.25		.000 ±0.15		X.° ±2.00°		CUSTOMER DRAWING		深圳市步步精科技有限公司 TITLE: TYPE-C 16P 母座 L=6.5 CH=0.78 沉板0.8 铜合金 端子镀金G/F 端子SMT 外壳5个焊点	
DRAWN/DATE	设计	TSP	SIZE:A4	UNIT:MM.	PART. NO:	126-221-160013-V2G							
CHECKED/DATE	审核	LYX	SCALE: 1:1	PROJECTION				REV.:		版本			
APPROVED/DATE	核准	LJP	DWG. PATH	0100-2				SHEET:		页码			

包装明细表 (The detail of the packing) Carton					
包装容量 (Packing Capacity)			重量 Weight (Kg)		
pcs/box	boxs/Carton	Pcs/Box	N.W./Pcs	N.W./Box	G.W./Box
1000	14	14000	—	—	—