

REV.	ECN NO	CONTENT	DATE	ENGINEER
A0				

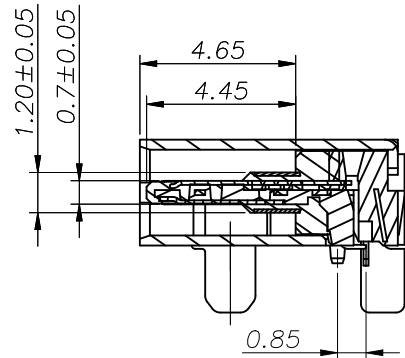

0.10
ALL TAILS

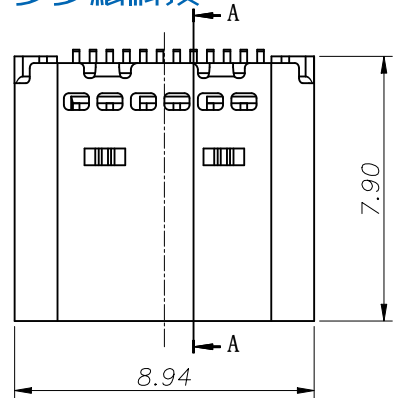

SECTION:A-A

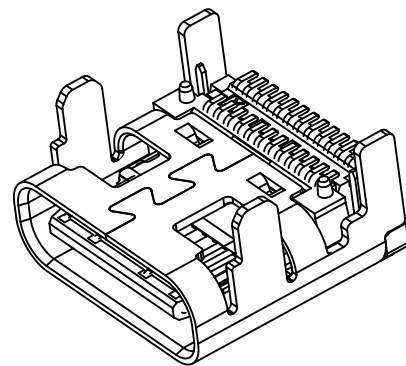
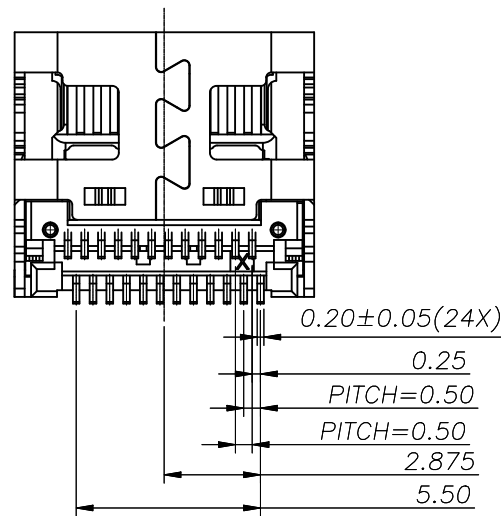
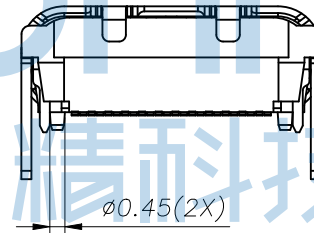
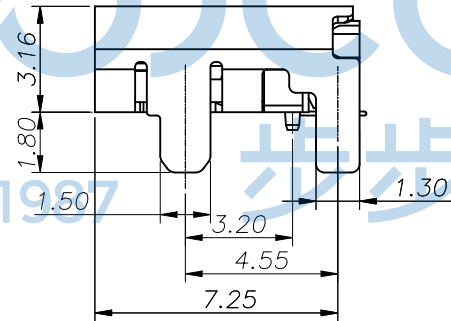
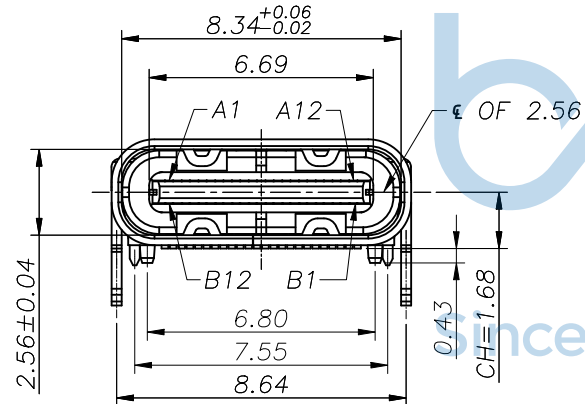

NOTE:

- MATERIAL SPECIFICATION:
 - HOUSING:HIGH TEMPERATURE RESISTANT PLASTIC,PA9T UL94 V-0.
 - CONTACTS:COPPER ALLOY C18150
 - MID PLATE: STAINLESS STEEL SUS301
 - FRONT SHELL: STAINLESS STEEL SUS304
 - EMI PLATE: STAINLESS STEEL SUS304
- PLATING SPECIFICATION:
 - CONTACTS:
 - Ni 50u" MIN. UNDER PLATED OVER ALL.
 - Au 30u" PLATED ON THE FUNCTIONAL AREA OF CONTACT. (GOLD PLATING THICKNESS FOLLOW)
 - FRONT SHELL:
 - Ni 30u" MIN. UNDER PLATED OVER ALL.
 - MID PLATE:
 - Ni 30u" MIN. UNDER PLATED OVER ALL.
 - Sn 80u"MIN. PLATED OVER ALL
 - EMI PLATE:
 - CLEAR ONLY
- MECHANICAL PERFORMANCE,
 - INSERTION FORCE: 0.5~2.0kgf.
 - REMOVAL FORCE: 0.8kgf~2.0kgf.
 - DURABILITY: 10000 CYCLES.
- ELECTRICAL PERFORMANCE,
 - CURRENT RATING:5.0A
VOLTAGE RATING:5.0V
 - LLCR:
 - VBUS & GND PINS AND OTHER PINS: 40m?/PIN MAX.
 - LLCR MAX. CHANGE OF ALL PINS: 10m?.
 - INSULATION RESISTANCE: 100M? MIN
 - DIELECTRIC WITHSTAND VOLTAGE,AC 100V FOR 1 MINUTE.
- ENVIRONMENTAL PERFORMANCE:
 - OPERATING TEMPERATURE: -25°C~+85°C.
- IR REFLOW:
 - THE PEAK TEMPERATURE ON THE BOARD SHALL BE MAINTAINED FOR 10 SECONDS AT 260°C.



THIS DOCUMENT IS THE SOLE PROPERTY OF BBJconn Technology Co.,Ltd. Corporation AND SHOULD NOT BE USED IN WHOLE OR IN PART WITHOUT PRIOR WRITTEN PERMISSION.		深圳市步步精科技有限公司	
.X: ±0.38 .XX: ±0.25 .XXX: ±0.13 X*: ±3" .X*: ±2" .XX*: ±1"		NAME: TYPE-C 24P 母座 板上四脚插 带柱 端子双排SMT L=7.90 CH=1.68 脚长1.80 镀金接触区30u 焊接区G-F	
APPD.	JM_Zheng	PJ. NO.: UC.01.52-12-0018 SIZE: A4 DRW NO.:	FINISH: SEE NOTES MAT'L.: SEE NOTES
CHKD.	LYX		
PDWG.NO:	0049-1	DR.	TSP
		SCALE: N/A	REV.: A0
		UNIT: mm	PAGE: 1/3

USB TYPE-C PIN ASSIGNMENTS

PIN NUMBER	SIGNAL NAME	PIN NUMBER	SIGNAL NAME
A1	GND	B12	GND
A2	TXp1	B11	RXp1
A3	TXn1	B10	RXn1
A4	VBUS	B9	VBUS
A5	CC1	B8	SBU2
A6	Dp1	B7	Dn2
A7	Dn1	B6	Dp2
A8	SBU1	B5	CC2
A9	VBUS	B4	VBUS
A10	RXn2	B3	TXn2
A11	RXp2	B2	TXp2
A12	GND	B1	GND

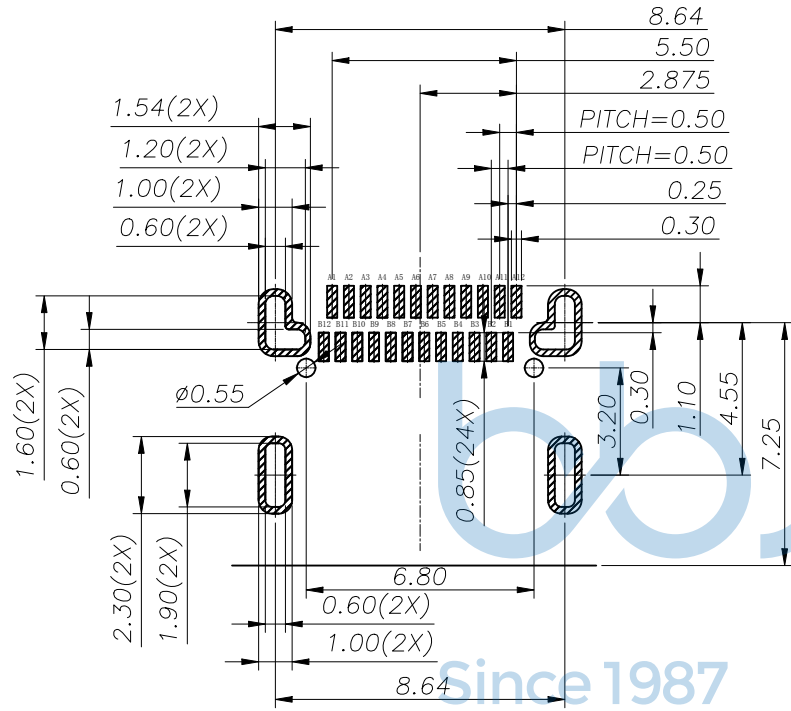

RECOMMENDED PCB LAYOUT(TOP VIEW)
THICKNESS 1.60MM;DEFAULT TOLERANCE:±0.05

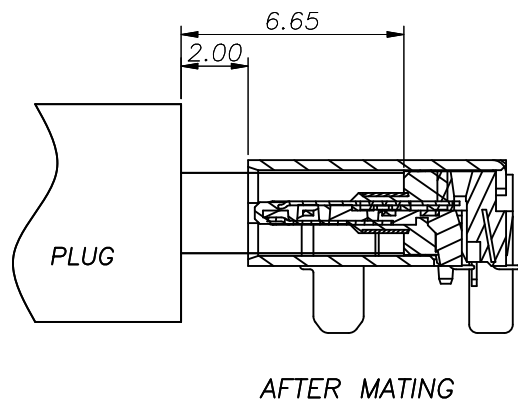

THIS DOCUMENT IS THE SOLE PROPERTY OF BBJconn Technology Co.,Ltd. Corporation AND SHOULD NOT BE USED IN WHOLE OR IN PART WITHOUT PRIOR WRITTEN PERMISSION.		深圳市步步精科技有限公司 .X: ±0.38 .X': ±3" .XX: ±0.25 .X'': ±2" .XXX: ±0.13 .XX': ±1"		NAME: TYPE-C 24P 母座 板上四脚插 带柱 端子双排SMT L=7.90 CH=1.68 脚长1.80 镀金接触区30u 焊接区G-F	
APPD.	JM_Zheng	PJ. NO.: UC.01.52-12-0018 SIZE: A4 DRW NO.:		FINISH: SEE NOTES MAT'L.: SEE NOTES	
CHKD.	LYX	SCALE: N/A		REV.:	A0
PDWG.NO:	0049-1	DR.	TSP	UNIT:	mm
				PAGE:	2/3

REV.	ECN NO	CONTENT	DATE	ENGINEER
AO				

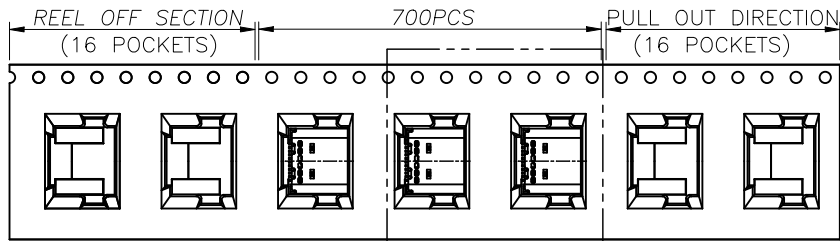

SEE DETAIL X

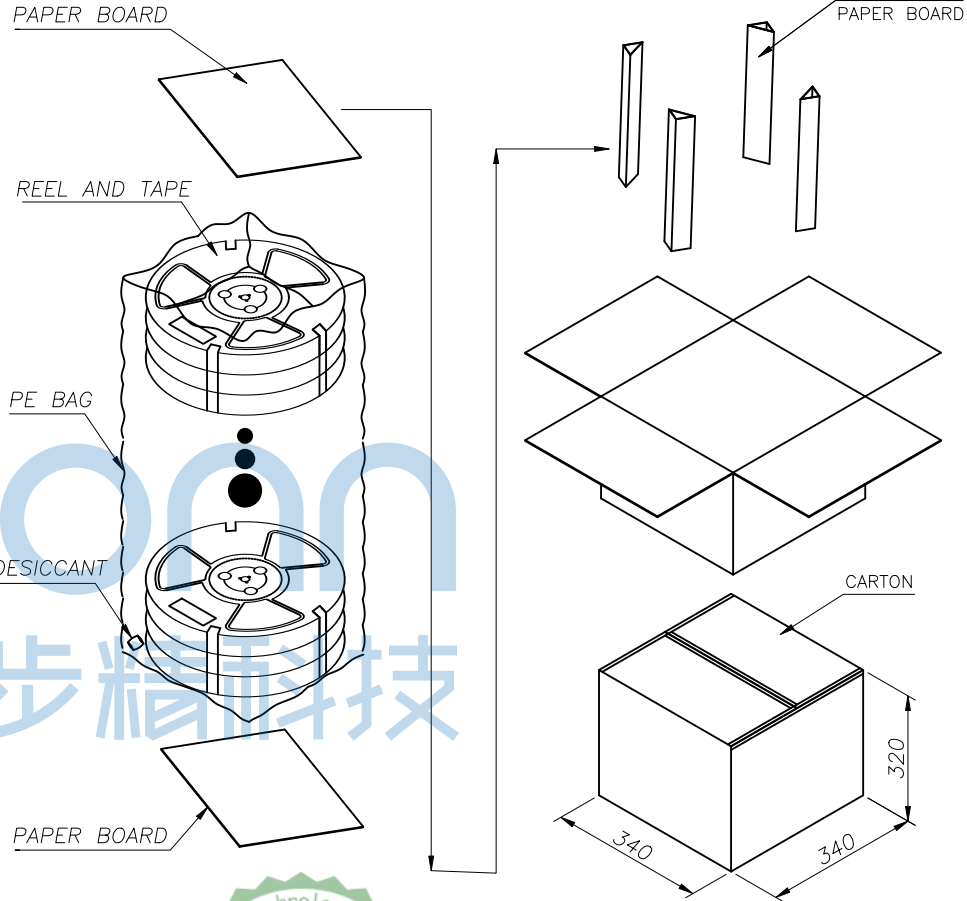
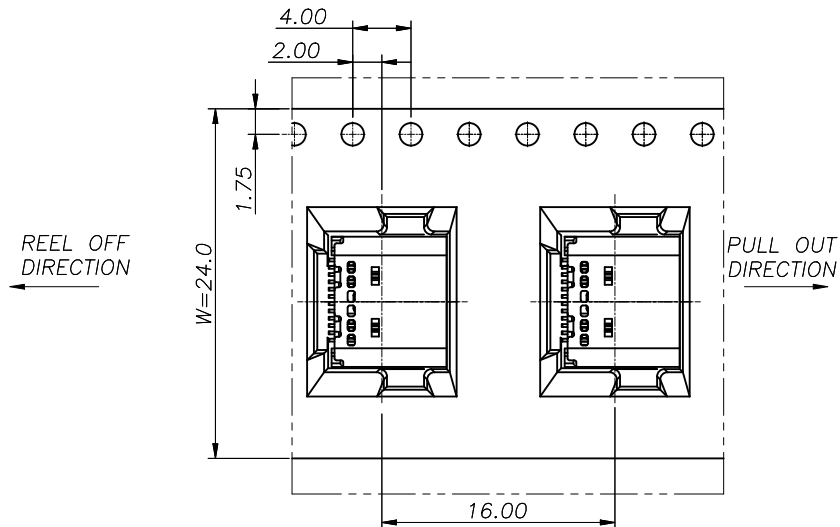
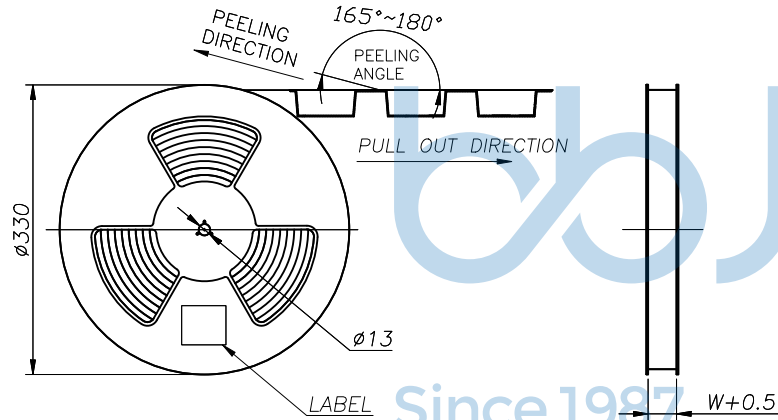

	REEL	CARTON
CONNECTOR (PCS)	700	7000

THIS DOCUMENT IS THE SOLE PROPERTY OF BBJconn Technology Co., Ltd. Corporation AND SHOULD NOT BE USED IN WHOLE OR IN PART WITHOUT PRIOR WRITTEN PERMISSION.

PDWG.NO: 0049-1

APPD. JM_Zheng
CHKD. LYX
DR. TSP

NAME: TYPE-C 24P 母座 板上四脚插 带柱 端子双排SMT
L=7.90 CH=1.68 脚长1.80 镀金接触区30u 焊接区G-F

PJ. NO.: UC.01.52-12-0018
SIZE: A4 DRW NO.:

FINISH: SEE NOTES MAT'L.: SEE NOTES
SCALE: N/A REV.: AO UNIT: mm PAGE: 3/3

深圳市步步精科技有限公司